

MV-CA032-10GM/GC

3.2 MP 1/1.8" CMOS GigE Area Scan Camera

GEN*ic*AM

GigE
VISION



Introduction

MV-CA032-10GM/GC camera adopts Sony IMX265 sensor to provide high-quality image. It uses GigE interface to transmit non-compressed images in real time with max. frame rate reaching 37.5 fps.

Key Feature

- Adopts GigE interface and max. transmission distance of 100 meters without relay.
- Supports auto and manual adjustment for exposure control, LUT, Gamma correction, etc.
- Up to 128 MB local memory for burst transmission and retransmission.
- Supports hardware trigger, software trigger, etc.
- Compatible with GigE Vision Protocol V2.0, GenICam Standard, and third-party software based on these protocol and standard.

Available Model

- Mono camera: MV-CA032-10GM
- Color camera: MV-CA032-10GC

Applicable Industry

Electronic semiconductor, factory automation, food and beverage, medical packaging, etc.

Sensor Quantum Efficiency

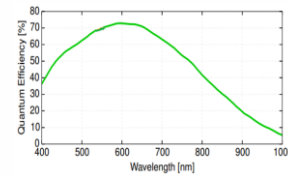

MV-CA032-10GM

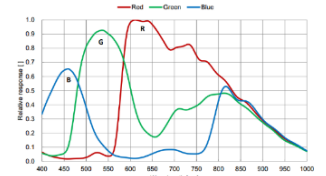

MV-CA032-10GC

Dimension

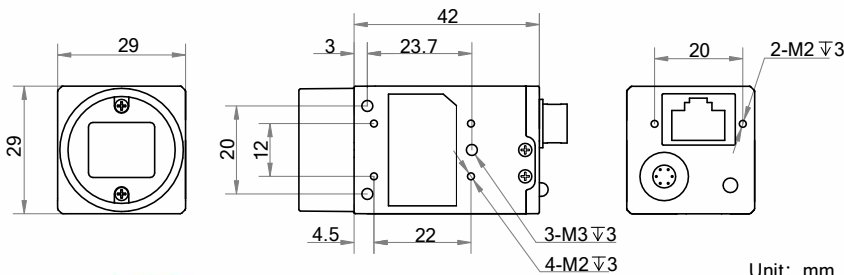

Unit: mm



en.hikrobotics.com



Aremak Bilişim Teknolojileri
Endüstriyel Görüntü İşleme Çözümleri

Adres: ODTÜ Teknokent Bilişim ve İnovasyon Merkezi,
Mustafa Kemal Mahallesi, Dumlupınar Bulvarı No:280G,
İç Kapı No:1260, Çankaya, Ankara/Türkiye

W: www.aremak.com.tr
E: shop@aremak.com.tr
T: +908502551506

Specification

| Model | MV-CA032-10GM | MV-CA032-10GC |
|---------------------------|---|--|
| Camera | | |
| Sensor type | CMOS, global shutter | |
| Sensor model | Sony IMX265 | |
| Pixel size | 3.45 μm x 3.45 μm | |
| Sensor size | 1/1.8" | |
| Resolution | 2048 x 1536 | |
| Max. frame rate | 37.5 fps @2048 x 1536 | |
| Dynamic range | 73 dB | |
| SNR | 40 dB | |
| Gain | 0 dB to 20 dB | |
| Exposure time | UltraShort exposure mode: 1 μs to 14 μs Standard exposure mode: 15 μs to 10 sec | |
| Exposure mode | Off/Once/Continuous exposure mode | |
| Mono/color | Mono | Color |
| Pixel format | Mono 8/10/10p/12/12p | Mono 8/10/12, Bayer RG 8/10/10p/12/12p, YUV422Packed, YUV422_YUYV_Packed, RGB 8, BGR 8 |
| Binning | Supports 1 x 1, 1 x 2, 2 x 1, 1 x 4, 4 x 1, 2 x 2, 2 x 4, 4 x 2, 4 x 4 | |
| Decimation | Supports 1 x 1, 1 x 2, 2 x 1, 2 x 2 | |
| Reverse image | Supports horizontal and vertical reverse image output | |
| Image buffer | 128 MB | |
| Electrical feature | | |
| Data interface | Gigabit Ethernet, compatible with Fast Ethernet | |
| Digital I/O | 6-pin Hirose connector provides power and I/O, including opto-isolated input x 1 (Line0), opto-isolated output x 1 (Line1), and bi-directional non-isolated I/O x 1 (Line2) | |
| Power supply | 12 VDC, supports PoE | |
| Power consumption | Typ. 3.2 W@12 VDC | Typ. 3.5 W@12 VDC |
| Mechanical | | |
| Lens mount | C-Mount | |
| Dimension | 29 mm x 29 mm x 42 mm (1.1" x 1.1" x 1.7") | |
| Weight | Approx. 68 g (0.15 lb.) | |
| Ingress protection | IP30 (under proper lens installation and wiring) | |
| Temperature | Working temperature: 0 °C to 50 °C (32 °F to 122 °F) Storage temperature: -30 °C to 70 °C (-22 °F to 158 °F) | |
| Humidity | 20% to 80% RH, non-condensing | |
| General | | |
| Client software | MVS or third-party software meeting with GigE Vision Protocol | |
| Operating system | 32/64-bit Windows XP/7/10, 32/64-bit Linux and 64-bit MacOS | |
| Compatibility | GigE Vision V2.0, GenICam | |
| Certification | CE, FCC, RoHS, KC | |

HIKROBOT

Hangzhou Hikrobot Co., Ltd.
en.hikrobotics.com

© Hangzhou Hikrobot Co., Ltd. All Rights Reserved.

Hangzhou Hikrobot does not tolerate any infringement. Any organization or individual may not imitate or reproduce in whole or in part of the content. The data herein is based on Hikrobot's internal evaluation. Actual data may vary depending on specific configuration and operating condition. The information herein is subject to change without notice. All the content has been checked conscientiously. Nevertheless, Hikrobot shall not be liable to damages resulting from errors, inconsistencies or omissions.



Aremak Bilişim Teknolojileri
Endüstriyel Görüntü İşleme Çözümleri

Adres: ODTÜ Teknokent Bilişim ve İnovasyon Merkezi,
Mustafa Kemal Mahallesi, Dumlupınar Bulvarı No:280G,
İç Kapı No:1260, Çankaya, Ankara/Türkiye

W: www.aremak.com.tr
E: shop@aremak.com.tr
T: +908502551506