

MV-CH800-60TM

80 MP CMOS 10 GigE Area Scan Camera



GEN<I>CAM

10GiGE
VISION

Introduction

MV-CH800-60TM camera adopts CMOS sensor to provide high-quality image. It uses 10 GigE interface to transmit non-compressed image in real time, and its max. frame rate can reach 15 fps in full resolution.

Key Feature

- Resolution of 10304 × 7712, and pixel size of 2.9 μm × 2.9 μm.
- Supports auto or manual adjustment of exposure time and white balance, and manual adjustment of gain, LUT, Gamma correction, etc.
- Adopts 10 GigE interface providing max. transmission distance of 100 meters without relay.
- Compact design with mounting holes on panels for flexible mounting.
- Compatible with GigE Vision Protocol V2.0, GenICam Standard, and third-party software based on protocols.

Available Model

MV-CH800-60TM-M58S-NN

Applicable Industry

PCB AOI, FPD, railway related applications, PV, etc.

Sensor Quantum Efficiency

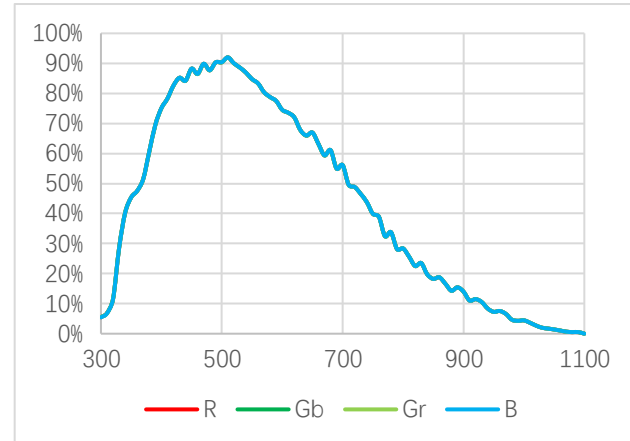

Dimension

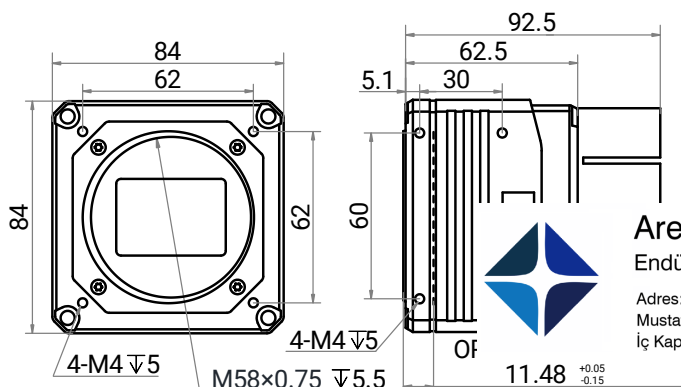

Aremaç Biliřim Teknolojileri
Endüstriyel Görüntü İřleme Çözümleri

Adres: ODTÜ Teknokent Biliřim ve İnovasyon Merkezi,
Mustafa Kemal Mahallesi, Dumlupınar Bulvarı No:280G,
İç Kapı No:1260, Çankaya, Ankara/Türkiye

W: www.aremak.com.tr
E: shop@aremak.com.tr
T: +908502551506

Unit: mm

Specification

Model	MV-CH800-60TM
Camera	
Sensor type	CMOS, global shutter
Sensor model	Stacked BSI
Pixel size	2.9 μm \times 2.9 μm
Sensor size	30 mm \times 22.4 mm
Resolution	10304 \times 7712
Max. frame rate	15 fps @ 10304 \times 7712 Mono 8
Dynamic range	75.7 dB
SNR	42 dB
Gain	0 dB to 24 dB
Exposure time	68 μs to 10 sec
Exposure mode	Off/Once/Continuous exposure mode
Mono/color	Mono
Pixel format	Mono 8/10/10Packed/12/12Packed
Binning	Supports 1 \times 1, 1 \times 2, 1 \times 4, 2 \times 1, 2 \times 2, 2 \times 4, 4 \times 1, 4 \times 2, 4 \times 4
Decimation	Supports 1 \times 1, 1 \times 2, 1 \times 4, 2 \times 1, 2 \times 2, 2 \times 4, 4 \times 1, 4 \times 2, 4 \times 4
Reverse image	Supports horizontal and vertical reverse image output
Electrical feature	
Data interface	10 Gigabit Ethernet (10000 Mbit/s), compatible with Gigabit Ethernet (1000 Mbit/s)
Digital I/O	12-pin P10 connector provides power and I/O, including opto-isolated input \times 1 (Line 0), opto-isolated output \times 1 (Line 1), bi-directional non-isolated I/O \times 1 (Line 2), and RS-232 \times 1
Power supply	9 VDC to 24 VDC
Power consumption	Typ. 11.7 W @ 12 VDC
Mechanical	
Lens mount	M58 \times 0.75, flange back length 11.48 mm
Dimension	84 mm \times 84 mm \times 92.5 mm (3.3" \times 3.3" \times 3.6")
Weight	Approx. 600 g (1.3 lb.)
Ingress protection	IP40 (under proper lens installation and wiring)
Temperature	Working temperature: 0 $^{\circ}\text{C}$ to 50 $^{\circ}\text{C}$ (32 $^{\circ}\text{F}$ to 122 $^{\circ}\text{F}$) Storage temperature: -30 $^{\circ}\text{C}$ to 80 $^{\circ}\text{C}$ (-22 $^{\circ}\text{F}$ to 176 $^{\circ}\text{F}$)
Humidity	20% RH to 95% RH (no condensation)
General	
Client software	MVS or third-party software meeting with GigE Vision Protocol
Operating system	32/64-bit Windows XP/7/10/11, 32/64-bit Linux
Compatibility	GigE Vision V2.0, GenICam
Certification	CE, RoHS, KC

