

MV-CH210-90YM/YC

21 MP CMOS CoaXPress Area Scan Camera



GEN< i >CAM

Introduction

MV-CH210-90YM/YC camera adopts Gsprint 4521 sensor to provide high-quality image. It uses CXP-12 interface to transmit non-compressed images in real time, and its max. frame rate can reach 222 fps in full resolution.

Key Feature

- Resolution of 5120 × 4096, pixel size of 4.5 μm × 4.5 μm.
- Adopts global shutter CMOS to provide high dynamic range, SNR, and high-quality images.
- Supports LSC sequencer polling function.
- Low power consumption without fans.
- Adopts CXP-12 interface to transmit data.
- Compatible with CoaXPress Protocol and GenICam Standard.

Dimension

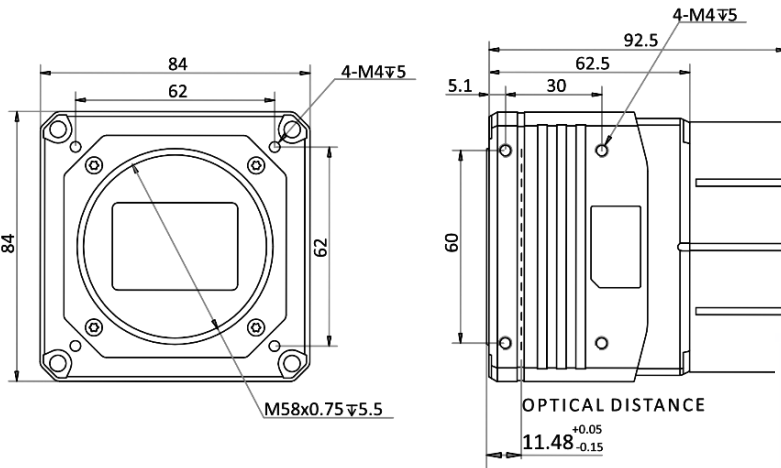

Available Model

- Mono camera:
MV-CH210-90YM-M58S-NN
- Color camera:
MV-CH210-90YC-M58S-NN

Applicable Industry

Electronics, semiconductor, PCB AOI, 3D application, motion capture, etc.

Sensor Quantum Efficiency

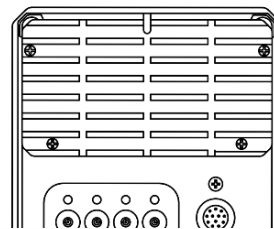
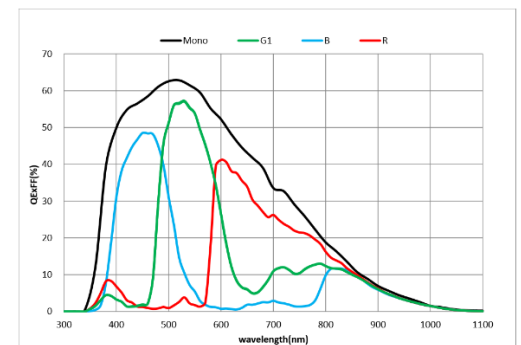

Arema Bilşim Teknolojileri
Endüstriyel Görüntü İşleme Çözümleri

Adres: ODTÜ Teknokent Bilşim ve İnovasyon Merkezi,
Mustafa Kemal Mahallesi, Dumlupınar Bulvarı No:280G,
İç Kapı No:1260, Çankaya, Ankara/Türkiye

W: www.aremak.com.tr
E: shop@aremak.com.tr
T: +908502551506

Specification

Model	MV-CH210-90YM	MV-CH210-90YC
Camera		
Sensor type	CMOS, global shutter	
Sensor model	Gpixel Gsprint 4521	
Pixel size	4.5 μm × 4.5 μm	
Sensor size	23.04 mm × 18.43 mm	
Resolution	5120 × 4096	
Max. frame rate	222 fps @ 5120 × 4096 Mono 8	222 fps @ 5120 × 4096 Bayer GB 8
Dynamic range	65 dB	
SNR	43 dB	
Gain	Supports 1.0 ×, 2.0 ×, 4.0 ×	
Exposure time	4 μs to 10 sec	
Exposure mode	Off/Once/Continuous exposure mode	
Mono/color	Mono	Color
Pixel format	Mono 8/10/12	Bayer GB 8/10/12
Binning	Supports 1 × 1, 1 × 2, 1 × 4, 2 × 1, 2 × 2, 2 × 4, 4 × 1, 4 × 2, 4 × 4	
Decimation	Supports 1 × 1, 1 × 2, 1 × 4, 2 × 1, 2 × 2, 2 × 4, 4 × 1, 4 × 2, 4 × 4	
Reverse image	Supports horizontal and vertical reverse image output	
Electrical features		
Data interface	CoaXPress with Micro-BNC interface	
Digital I/O	12-pin P10 connector provides power and I/O, including opto-isolated input × 1 (Line 0), opto-isolated output × 1 (Line 1), bi-directional non-isolated I/O × 1 (Line 2), and RS-232 × 1.	
Power supply	12 VDC to 24 VDC, CXP-0 and CXP-1 connectors support PoCXP	
Power consumption	Typ. 18 W @ 24 VDC	Typ. 16.3 W @ 24 VDC
Mechanical		
Lens mount	M58 × 0.75, flange back length 11.48 mm	
Dimension	84 mm × 84 mm × 62.5 mm (3.3" × 3.3" × 2.5")	
Weight	Approx. 650 g (1.4 lb.)	
Ingress protection	IP40 (under proper lens installation and wiring)	
Temperature	Working temperature: 0 °C to 50 °C (32 °F to 122 °F) Storage temperature: -30 °C to 70 °C (-22 °F to 158 °F)	
Humidity	20% RH to 95% RH (no condensation)	
General		
Client software	MVS or frame grabber software meeting with CoaXPress Protocol	
Operating system	32/64-bit Windows 7/10	
Compatibility	CoaXPress, GenICam	
Certification	CE, RoHS, KC	

