

# MV-CH140-60UM

14 MP 1" CMOS USB3.0 Area Scan Camera



**GEN*i*CAM**

**USB<sup>TM</sup>**  
VISION

## Introduction

MV-CH140-60UM camera provides high-quality images. It uses USB3.0 interface to transmit non-compressed images in real time, and its max. frame rate can reach 27 fps in full resolution.

## Key Feature

- Supports auto or manual adjustment of gain, exposure time, Gamma correction, LUT correction, etc.
- Supports customized ROI, horizontal and vertical reverse image output.
- Supports hardware trigger, software trigger, free run.
- Compatible with USB3 Vision Protocol, GenICam Standard, and the third-party software based on the protocol and standard.

## Dimension

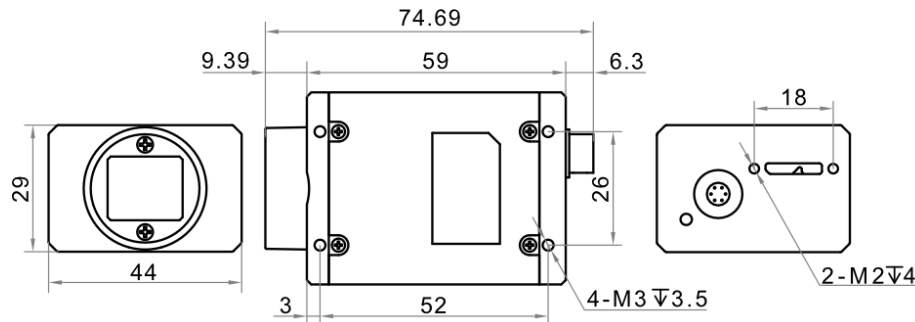

Unit: mm



**Aremak Bilişim Teknolojileri**  
Endüstriyel Görüntü İşleme Çözümleri

Adres: ODTÜ Teknokent Bilişim ve İnovasyon Merkezi,  
Mustafa Kemal Mahallesi, Dumlupınar Bulvarı No:280G,  
İç Kapı No:1260, Çankaya, Ankara/Türkiye

W: [www.aremak.com.tr](http://www.aremak.com.tr)  
E: [shop@aremak.com.tr](mailto:shop@aremak.com.tr)  
T: +908502551506

## Available Model

MV-CH140-60UM

## Applicable Industry

Electronic semiconductor, factory automation, liquor and beverage, medicine packing, screen AOI detection, etc.

## Sensor Quantum Efficiency

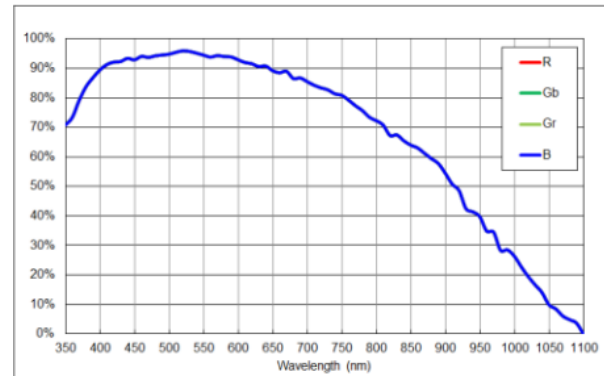

## Specification

<b>Model</b>	<b>MV-CH140-60UM</b>
<b>Performance</b>	
<b>Sensor type</b>	CMOS, global shutter
<b>Sensor model</b>	Stacked BSI
<b>Pixel size</b>	3 $\mu\text{m}$ $\times$ 3 $\mu\text{m}$
<b>Sensor size</b>	1"
<b>Resolution</b>	4708 $\times$ 2824
<b>Max. frame rate</b>	27 fps @4708 $\times$ 2824 Mono 8
<b>Dynamic range</b>	56.9 dB
<b>SNR</b>	41.9 dB
<b>Gain</b>	0 dB to 24 dB
<b>Exposure time</b>	80 $\mu\text{s}$ to 10 sec
<b>Exposure mode</b>	Off/Once/Continuous exposure mode
<b>Mono/color</b>	Mono
<b>Pixel format</b>	Mono 8/10/10Packed/12/12Packed
<b>Binning</b>	Supports 1 $\times$ 1, 2 $\times$ 2, 4 $\times$ 4
<b>Decimation</b>	Supports 1 $\times$ 1, 2 $\times$ 2, 4 $\times$ 4
<b>Reverse image</b>	Supports horizontal and vertical reverse image output
<b>Electrical features</b>	
<b>Data interface</b>	USB3.0, compatible with USB2.0
<b>Digital I/O</b>	6-pin P7 connector provides power and I/O, including opto-isolated input $\times$ 1 (Line 0), opto-isolated output $\times$ 1 (Line 1), bi-directional non-isolated I/O $\times$ 1 (Line 2).
<b>Power supply</b>	9 VDC to 24 VDC, supports USB3.0 power supply
<b>Power consumption</b>	Typ. 4.0 W@5 VDC (USB3.0 provides power supply)
<b>Mechanical</b>	
<b>Lens mount</b>	C-mount
<b>Dimension</b>	29 mm $\times$ 44 mm $\times$ 59 mm (1.1" $\times$ 1.7" $\times$ 2.3")
<b>Weight</b>	Approx. 113 g (0.2 lb.)
<b>Ingress protection</b>	IP40 (under proper lens installation and wiring)
<b>Temperature</b>	Working temperature: -10 $^{\circ}\text{C}$ to 50 $^{\circ}\text{C}$ (14 $^{\circ}\text{F}$ to 122 $^{\circ}\text{F}$ ) Storage temperature: -30 $^{\circ}\text{C}$ to 70 $^{\circ}\text{C}$ (-22 $^{\circ}\text{F}$ to 158 $^{\circ}\text{F}$ )
<b>Humidity</b>	20% to 95% RH, non-condensing
<b>General</b>	
<b>Client software</b>	MVS or third-party software meeting with USB3 Vision Protocol
<b>Operating system</b>	32/64-bit Windows XP/7/10, 64-bit Windows 11, 32/64-bit Linux and 64-bit MacOS
<b>Compatibility</b>	USB3 Vision, GenICam
<b>Certification</b>	CE, RoHS

